

Multi building public building with StiroFert
girder grill construction with grid axis (8m, 10m, 12m or even 15m)

- It has small mass
and it is very rigid,
so it is highly recommended
for areas with earthquakes
- With no harmful effects for health
- fire resistant
- Prefabricated floor construction, economically proved

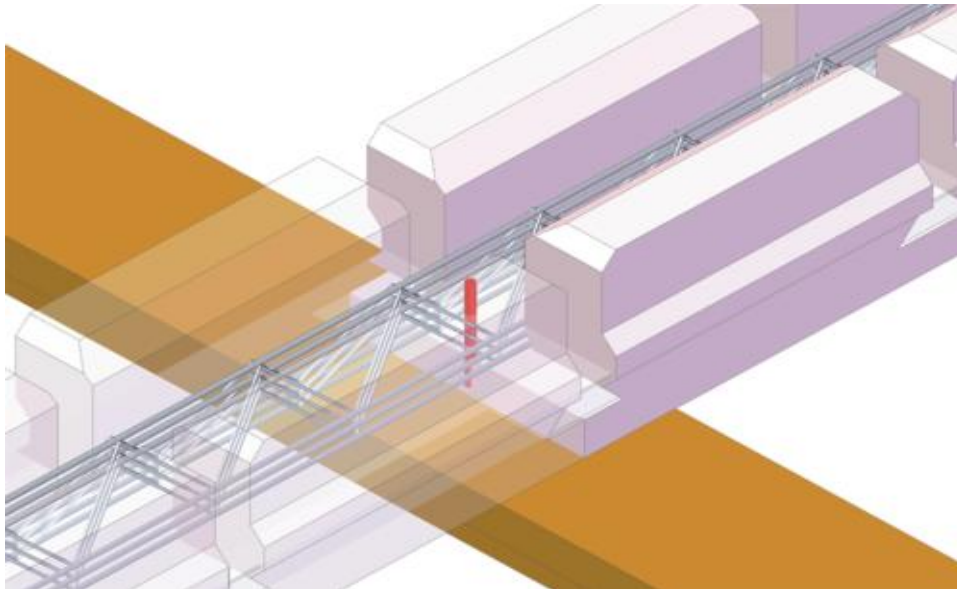

Cotter, profile built in during concreting. Cutter can be seen at the lower side of construction and it points

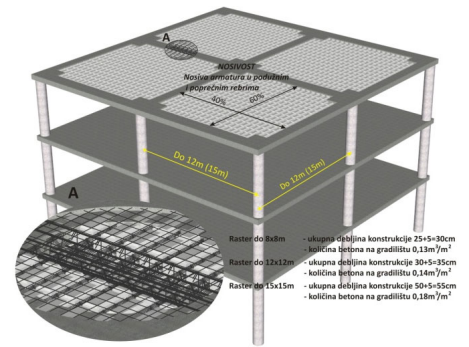
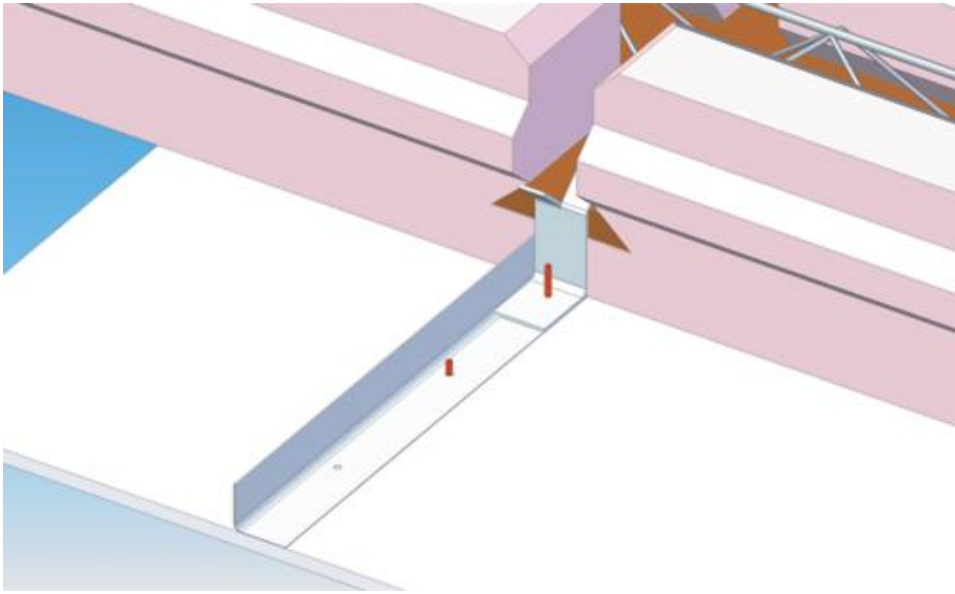

Details of construction used for mounting gypsum plates. Core plates are built in during concreting, one